

## SONIQUE

### SONIQUE THERMOSTATIC RECESSED SHOWER VALVE WITH ADJUSTABLE RISER



### Product Specification

Product Code:	SQ02 SHCAR C
Finish:	Chrome
Product Type:	Contemporary
Construction:	Body is of brass construction
Cartridge Type:	Thermostatic cartridge
Supply:	Suitable for all plumbing systems, preferably balanced
Inlet Connections:	15mm compression elbows
Outlet Connection:	G 1/2"
Water Pressure:	Min. 0.1 bar, Max. 5.0 bar
Dimensions for Fitting:	152 mm inlet centres

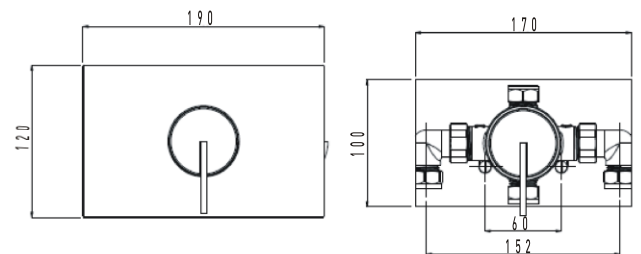

### Additional Information

- Single Lever Control - Flow and temperature are controlled by an easily operated single handle
- Thermostatic cartridge maintains showering temperature to +/- 1°C by compensating for changes in the incoming water temperature and pressure providing a stable outlet temperature.
- Automatic shut off in the event of hot or cold water supply failure, thus reducing the risk of injury.
- Factory set to a maximum of 43°C to eliminate the ability to select an unsafe temperature this can be adjusted to suit user preference.
- Supplied with 1.5m shower hose, riser rail, hose retainer, single function handset with rub clean Nozzles and concealing plate. Riser brackets can be adjusted to cover existing holes in the wall surface.
- Suitable for wall cavity depths between 43-67mm.
- Chrome plated to BS EN 248.
- Swivel inlet elbows with 152mm centres. Valve can be fed from top, bottom or rear.

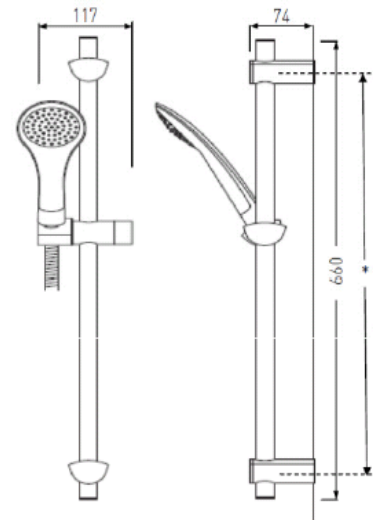

**Technical Advice:** For further information please call 0844 7016273 or email [customercare@bristan.com](mailto:customercare@bristan.com).

**Guarantee:** 5 years covering manufacturing faults.

### Flow Rates (litres per minute, open outlet)

System Pressure	0.1bar	0.2bar	0.5bar	1bar	2bar	3bar	5bar
With flow regulators fitted	--	--	--	7.3	8.0	8.7	9.2
Without flow regulators fitted	5.7	9.0	15.6	--	--	--	--

