

stuart

Kennet Centrifugal Pumps

The Kennet range of centrifugal pumps are designed for high flow applications requiring continuous operation.

Motor, impeller and seal options are available.

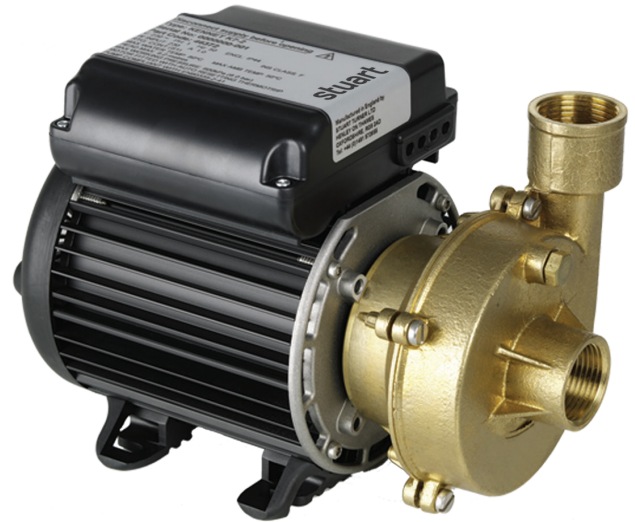

Features

- Robust design
- Acetal or brass impeller options
- Seal material options
- Quiet operation
- Flow rates up to 210 l/min
- Continuous (S1) duty rating
- IP44 enclosure protection

Application

- The Kennet range of centrifugal pumps is designed for liquid transfer, pressure boosting or distribution of clean, fresh water. Other clean, non aggressive, non explosive liquids with similar characteristics to water may be pumped

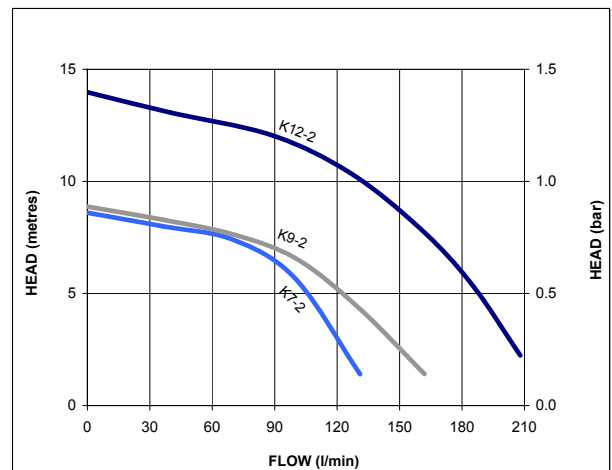

For further advice on selecting the correct pump call or e-mail info@stpumps.co.uk

pumpassist
HELPLINE +44 (0) 844 98 000 97

stuart

Pump Model		K7-2 46372	K9-2 46374	K12-2 46379	K12-2 46381	K12-2 46383
General	Guarantee	1 year				
Features	Pump type	Centrifugal				
	Mechanical seal	Nitrile / Carbon / Silicon Carbide				Viton / Carbon / Silicon Carbide
	Impeller	Acetal			Brass	
	Priming vent plug	✓	✓	✓	✓	✓
Performance	Maximum head (closed valve)	8.8 metres	9.1 metres	14.2 metres		
	Performance @ 60 l/min	7.8 metres	8.1 metres	13.1 metres		
	Performance @ 120 l/min	3.1 metres	5.3 metres	11.0 metres		
	Maximum flow	132 l/min	164 l/min	210 l/min		
	Minimum static inlet pressure	0.05 bar (0.5 metres)				
	Maximum static inlet pressure	1 bar (10 metres)				
	Maximum viscosity	50 secs redwood no. 1 9.5 centistokes				
	Maximum working pressure*	600 kPa (6 bar)				
	Maximum ambient air temperature	40 °C				
	Min / Max water temperature	Min 4 °C / Max 80 °C				
	Suction lift**	4.6 metres				
Connections	Pump connections	G 1 female				
Motor	Type	Induction, auto-reset thermal trip				
	Duty rating	Continuous (S1)				
Electrical	Power supply / phase / frequency	230 V a.c. / 1 / 50 Hz				
	Current (full load)	1.0 Amps	1.5 Amps	2.8 Amps		
	Power consumption	230 Watts	330 Watts	595 Watts		
	Fuse rating	5 Amps				
	Power cable (pre-wired)	1.5 metres				
Physical	Enclosure protection	IP44				
	Length	242 mm		277 mm		
	Width	131 mm				
	Height (excluding hoses)	170 mm				
	Weight (including fittings)	5.3 Kg	5.7 Kg	7.6 Kg		

* The maximum pressure that can be applied to the pump under any installation conditions.

** With footvalve fitted

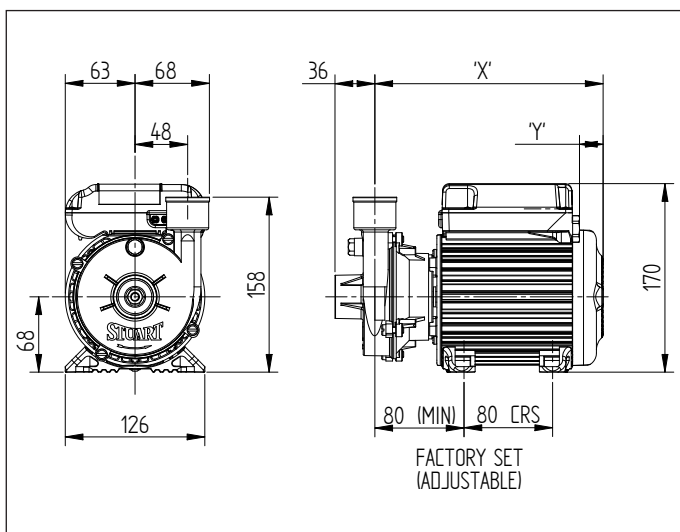

Pump Description	Dim. 'X'	Dim. 'Y'
K7-2	206 mm	21 mm
K9-2	206 mm	21 mm
K12-2	241 mm	56 mm

Stuart Turner Limited reserves the right to amend specifications without notice.